

Coupler

110-M-241(-R)

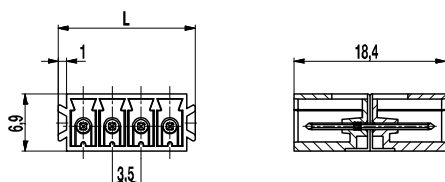

110-M-241

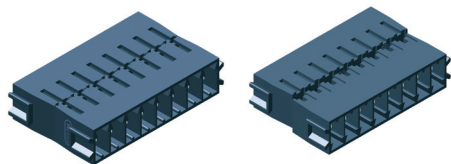
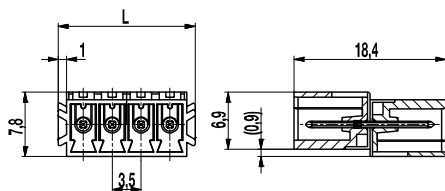

110-M-241-R

All couplers consist of two vertical pin strips 110-M assembled back-to-back with continuous pins for both pin strips. This allows plugging and coding on both sides.

In addition, pin strips with connecting flange can be screw connected with each other or alternatively with plug connectors. Rotating one pin strip generates the R-variant (R for reverse), on which pole markings of both plug connectors match.

Advantages:

- Pre-assembled functional units can be quickly connected and disconnected
- Shorter assembly times, easier unit exchange
- Current handling capability identical to all other 110-products
- Coding possibility
- Printed upon request with markings readable in plugged condition
- Easier maintenance and trouble-shooting

Part Numbers

No. of poles	110-M-241	110-M-241-R	Length	Pcs
2	10.841.702	40.841.702	9,60	100
3	10.841.703	40.841.703	13,10	100
4	10.841.704	40.841.704	16,60	50
8	10.841.708	40.841.708	30,60	25
12	10.841.712	40.841.712	44,60	25

further number of poles on request

General Information

Pitch	3,5 mm
No. of poles	2 - 12
Usable with	all plug connectors of series 110

Technical Data

Overvoltage Category	III	III	II
Pollution Severity Level	3	2	2
Rated Voltage	160 V	160 V	320 V
Rated Impulse Voltage	2,5 kV	2,5 kV	2,5 kV
Rated Insulation Voltage	130 V acc. to EN 60998-1		
Rated Current	8 A		

Material

Moulding	PA, grey, V-0
Comparative Tracking Index	CTI ≥ 600
Insulating Group	I
Temperature Range	-40°C up to 100°C
Pin	0,8 x 0,8 mm; tin plated brass

Approvals

	Current	Voltage	Group	AWG	Nm
	8	300	B		
	8	300	B		

Options / Accessories

- Consecutive numbering
- Special marking according to drawing
- Self-adhesive marking strip BST-3,50

Coupler

110-M-241(-R)

ADDITION: Overview variants

110-M-241/..

Standard version

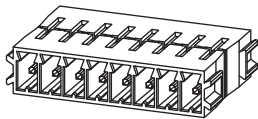

110-M-241/..-R

like 110-M-241,
but one pin strip turned 180°

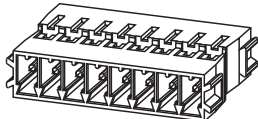

Matching Parts: 2x 110-A-111

Part numbers

No. of poles	110-M-241	110-M-241-R	Length	Pcs
2	10.841.702	40.841.702	9,60	100
3	10.841.703	40.841.703	13,10	100
4	10.841.704	40.841.704	16,60	50
8	10.841.708	40.841.708	30,60	25
12	10.841.712	40.841.712	44,60	25

further number of poles on request

110-M-245/..

like 110-M-241,
but both pin strips fixed together with screws

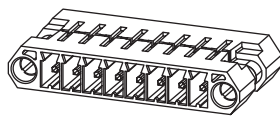

110-M-245/..-R

like 110-M-241,
but both pin strips fixed together with screws

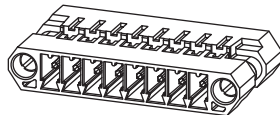

Part numbers

No. of poles	110-M-245	110-M-245-R	Length	Pcs
2	10.841.752		17,30	100
3			20,80	
4		40.841.754	24,30	50
8			38,30	
10	10.841.760	40.841.760	45,30	50

further number of poles on request

110-M-345/..

like 110-M-241,
but one pin strip with connecting flanges

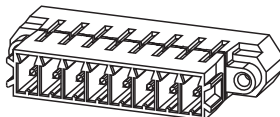

110-M-345/..-R

like 110-M-345,
but one pin strip turned 180°

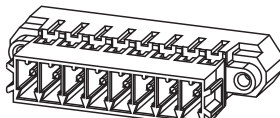

Matching Parts: 1x 110-A-111 and 1x 110-A-115

Part numbers

No. of poles	110-M-345	110-M-345-R	Length	Pcs
2	10.841.902	40.841.902	17,30	100
3			20,80	
4	10.841.904	40.841.904	24,30	50
8			38,30	
12	10.841.912	40.841.912	45,30	25

further number of poles on request

110-M-445/..

like 110-M-241,
but both pin strips with connecting flanges

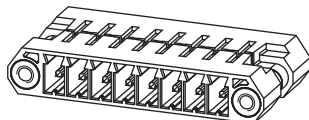

110-M-445/..-R

like 110-M-445,
but one pin strip turned 180°

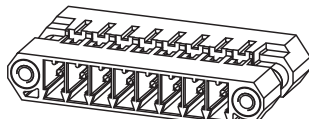

Matching Parts: 2x 110-A-115

Part numbers

No. of poles	110-M-445	110-M-445-R	Length	Pcs
2	10.841.927	40.841.927	17,30	100
3			20,80	
4	10.841.929	40.841.929	24,30	50
8			38,30	
12	10.841.937	40.841.937	45,30	50

further number of poles on request