

Pin strip 110-S-215

Staggered two-tier version, plug-in direction parallel to PCB, with connecting flanges

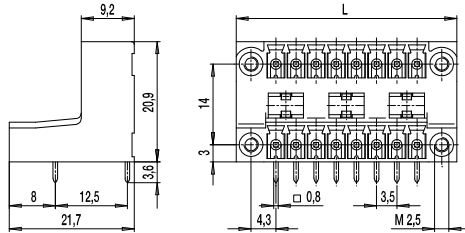

The pin strip 110-S-215 in staggered two-tier version with connecting flanges and a pitch of 3,5 mm is available in 4- to 44-pole design.

The plug direction for mating plug connectors is for this version parallel to the PCB board.

For its small dimensions it offers remarkable connection data (160 V-III-3 / 8 A).

The connecting flanges on both housing sides are equipped with M2,5 thread inserts (<0,3 Nm).

The corresponding plug connectors in connecting flange design feature lateral screws which offer vibration-proof screw-connection of the plug connector and also prevent unintended loosening.

For each pole, the pin strip has one trapezoidal coding slot in which the coding elements 120-K can be inserted.

Part Numbers

No. of poles	110-S-215	Length	PU
4	10.841.452	17,30	100
6	10.841.453	20,80	100
8	10.841.454	24,30	50
10	10.841.455	27,80	50
12	10.841.456	31,30	50
14	10.841.457	34,80	50
16	10.841.458	38,30	25
18	10.841.459	41,80	25
20	10.841.460	45,30	25
22	10.841.461	48,80	25
24	10.841.462	52,30	25
26	10.841.463	55,80	25
28	10.841.464	59,30	25
30	10.841.465	62,80	25
32	10.841.466	66,30	25
34	10.841.467	69,80	25
36	10.841.468	73,30	25
38	10.841.469	76,80	25
40	10.841.470	80,30	25
42	10.841.471	83,80	25
44	10.841.472	87,30	10

General Information

Pitch	3,5 mm
No. of poles	4 - 44
Usable with	all plug connectors of series 110 with connecting flanges

Technical Data

Overvoltage Category	III	III	II
Pollution Severity Level	3	2	2
Rated Voltage	160 V	160 V	320 V
Rated Impulse Voltage	2,5 kV	2,5 kV	2,5 kV
Rated Insulation Voltage	130 V acc. to EN 60998-1		
Rated Current	8 A		
Hole in PCB	ø 1,3 mm		

Material

Moulding	PA, grey, V-0
Comparative Tracking Index	CTI ≥ 600
Insulating Group	I
Temperature Range	-40°C up to 100°C
Solder pin	0,8 x 0,8 mm; tin plated brass

Approvals

	Current	Voltage	Group	AWG	Nm
	8	300	B, D		
	8	300	B		

Options / Accessories

- Consecutive numbering
- Special marking according to drawing
- Self-adhesive marking strip BST-3,50
- Pitch of 7 mm for larger clearance and creepage distances
- Coding elements 120-K
- With PCB location pin