

Plug connector

121-A-111

Screw connection

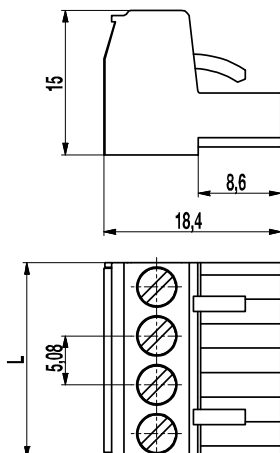

The plug connector 121-A-111, with a pitch of 5,08 mm, is available in 2- to 24-pole design and can be mounted side-by-side without pole loss.

For each pole the plug connector has one trapezoidal coding slot in which the coding elements 120-K can be inserted. The wire entrance is parallel to the plug direction.

The screws are captive.

Part Numbers

No. of poles	121-A-111	Length	Pcs
2	10.808.102	10,16	200
3	10.808.103	15,24	200
4	10.808.104	20,32	100
5	10.808.105	25,40	100
6	10.808.106	30,48	100
7	10.808.107	35,56	50
8	10.808.108	40,64	50
9	10.808.109	45,72	50
10	10.808.110	50,80	50
11	10.808.111	55,88	50
12	10.808.112	60,96	50
13	10.808.113	66,04	50
14	10.808.114	71,12	50
15	10.808.115	76,20	50
16	10.808.116	81,28	50
17	10.808.117	86,36	50
18	10.808.118	91,44	50
19	10.808.119	96,52	50
20	10.808.120	101,60	50
21	10.808.121	106,68	50
22	10.808.122	111,76	50
23	10.808.123	116,84	50
24	10.808.124	121,92	50

General Information

Pitch	5,08 mm
No. of poles	2 - 24
Usable with	all pin strips of series 121

Technical Data

Clamping Range	<i>solid / flexible / AWG</i>		
	0,2 - 4 mm ² / 0,2 - 2,5 mm ² / 26 - 12 AWG		
Rated Cross Section	2,5 mm ²		
Wire Stripping Length	7 mm ± 0,5 mm		
Overvoltage Category	III	III	II
Pollution Severity Level	3	2	2
Rated Voltage	250 V	320 V	630 V
Rated Impulse Voltage	4 kV	4 kV	4 kV
Rated Insulation Voltage	250 V acc. to EN 60998-1		
Rated Current	12 A		
Torque	0,5 Nm		

Material

Moulding	PA, grey, V-0
Comparative Tracking Index	CTI ≥ 600
Insulating Group	I
Temperature Range	-40°C up to 100°C
Terminal body	Nickel plated brass
Pressure clamp	Tin plated tin bronze
Screw	M3; zinc plated steel, blue passivated
Spring	Tin plated tin bronze

Approvals

	Current	Voltage	Group	AWG	Nm
	15	300	B	26 - 12	0,51
	10	300	D	26 - 12	0,51
	15	300	B	26 - 12	0,51
	10	300	D, E	26 - 12	0,51

Options / Accessories

- Consecutive numbering
- Special marking according to drawing
- Self-adhesive marking strip BST-5,08
- Pitch of 10,16 mm for larger clearance and creepage distances
- Coding elements 120-K
- Connectors equipped with coding elements on request
- Strain relief