

PCB connector for SMD

140-A-524-SMD

Screw connection, with solder flanges

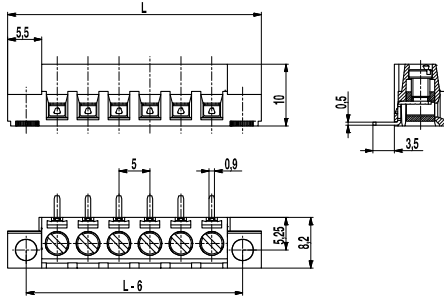

PCB Layout

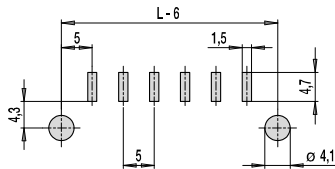

Solder paste thickness: 0,15 - 0,2 mm

The PCB terminals for surface mounting comprise several types for reflow processes.

The SMD terminals 140-A with 5 mm pitch are designed with screw connections in elevator clamping style. The terminal clamp is made out of one piece together with the soldering tag and securely attached to the moulding. The moulding is made of heat resistant thermoplastic resin and therefore most suitable for the reflow soldering process.

These PCB terminals are equipped with soldering flanges on both sides with torsion protection elements for reliable mechanical securing to the circuit board. They are transferred more to the front in comparison to the connector centre in order to keep the retaining strength, where the wires are connected. Thus, the force, acting on the solder pins, is reduced in a very important way.

The solder pins are exactly aligned parallel to the printed circuit board in order to create a coplanar connection after the reflow soldering process.

Packed in magazines or equipped with Pick Discs in Tape on Reel, this genuine SMD terminal is suitable for the automatic assembly.

Part Numbers

No. of poles	140-A-524-SMD	Length	Pcs
2	50.801.652	21	672
4	50.801.654	31	448
5	50.801.655	36	392
6	50.801.656	41	336
8	50.801.658	51	280
10	50.801.660	61	224
12	50.801.662	71	196

further number of poles on request

General Information

Centre to centre spacing	5 mm
No. of poles	2 - 12
Areas of application	Security and building industries

Technical Data

Clamping Range	<i>solid / flexible / AWG</i>		
	0,14 - 2,5 mm ² / 0,14 - 1,5 mm ² / 26 - 16 AWG		
Rated Cross Section	1,5 mm ²		
Wire Stripping Length	6 mm ± 0,5 mm		
Overvoltage Category	III	III	II
Pollution Severity Level	3	2	2
Rated Voltage	200 V	320 V	500 V
Rated Impulse Voltage	4 kV	4 kV	4 kV
Rated Insulation Voltage	250 V acc. to EN 60998-1		
Rated Current	15 A		
Soldering process	Reflow solder		
Torque	0,5 Nm		

Material

Moulding	PA HT, black, V-0
Comparative Tracking Index	CTI ≥ 600
Insulating Group	I
Temperature Range	-40°C up to 150°C; reflow solder temperature (Peak) max. 260°C (15-30 s)
Terminal Body	Nickel plated brass
Pressure clamp	Tin plated bronze
Screw	M3, zinc plated steel, blue passivated
Solder pin	0,5 x 0,9 mm; tin plated bronze
Solder cylinder	Tin plated brass

Approvals

	Current	Voltage	Group	AWG	Nm
	10	300	B,D	30 - 14	0,51 (1)
	15	300	B	30 - 14	0,51

(1) 20 A max for factory-wiring only.

Options / Accessories

- Consecutive numbering
- Special marking accord. drawing
- Self-adhesive marking strip BST-5,00

Part Numbers: Tape-on-Reel

No. of poles	140-A-524-SMD	Tape Width	Tape Height	Pcs
2	50.801.652.A00	32 mm	13 mm	375
3	50.801.653.A00	56 mm	13 mm	375
4	50.801.654.A00	56 mm	13 mm	375
5	50.801.655.A00	56 mm	13 mm	375
6	50.801.656.A00	56 mm	13 mm	375

further number of poles on request