

322-LFS(-DS)

Screw/solder terminal strip
Screw/solder tag connection

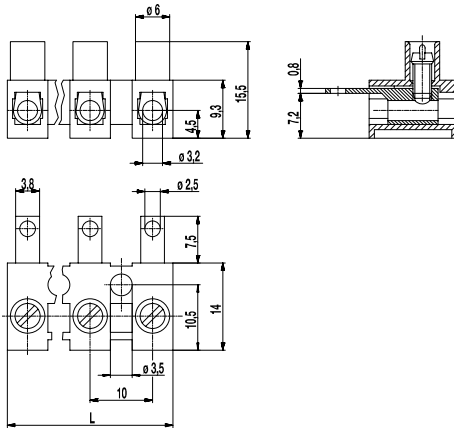
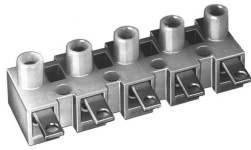

The screw/solder terminal strip 322-LFS in 10 mm pitch was designed for larger cross-sections than version 302-LF-DS. It is available with 1 to 12 poles. Mouldings of this type are open on the solder tag side but they can be connected safe-to-touch as 2- and 3-pole version with cover caps A-323 and base plates B-323. This will extend the creepage distance to the mounting surface. Socket and solder tag are manufactured in one piece.

The screws are ready to be wired, secured against self-loosening and captive.

These strips can be combined with plug-in terminal strip 322-SV by plugging the pins into the sockets and screwing them tight.

The wire protector of the "DS"-version reliably prevents damage to multi-wire flexible conductors by the turning screw. These terminal strips can be screw-mounted on a substrate.

Part Numbers

No. of poles	322-LFS	322-LFS-DS	Length	PU
1	10.821.002	23.821.002	8,00	3000
2	11.821.002	24.821.002	18,00	1000
3	12.821.002	25.821.002	28,00	1000
4	13.821.002	26.821.002	38,00	1000
5	14.821.002	27.821.002	48,00	500
6	15.821.002	28.821.002	58,00	140
7	16.821.002	29.821.002	68,00	90
8	17.821.002	30.821.002	78,00	90
9	18.821.002	31.821.002	88,00	80
10	19.821.002	32.821.002	98,00	70
11	20.821.002	33.821.002	108,00	70
12	21.821.002	34.821.002	117,00	70

General Information

Pitch	10 mm
No. of poles	1 - 12



Technical Data

Clamping Range	<i>solid / flexible / AWG</i>		
<i>without wire protector</i>	0,5 - 4 mm ² / 0,5 - 2,5 mm ² / 20 - 12 AWG		
<i>with wire protector</i>	0,34 - 2,5 mm ² / 0,34 - 2,5 mm ² / 22 - 14 AWG		
Rated Cross Section	2,5 mm ²		
Wire Stripping Length	7 mm ± 0,5 mm		
Overvoltage Category	III	III	II
Pollution Severity Level	3	2	2
Rated Voltage	320 V	320 V	630 V
Rated Impulse Voltage	4 kV	4 kV	4 kV
Rated Insulation Voltage	450 V acc. to EN 60998-1		
Rated Current	24 A		
Torque	0,5 Nm		

Material

Moulding	PA, natural, V-2
Comparative Tracking Index	CTI ≥ 600
Insulating Group	I
Temperature Range	-40°C up to 100°C
Terminal Body	Tin plated brass
Screw	M3, zinc plated steel, blue passivated
Wire protector	Tin plated tin bronze

Approvals

	Current [A]	Voltage [V]	Group	AWG	[Nm]
	10	300	B,D	20 - 12	0,51
	20	300	B	22-10 [1]	0,51
	10	300	D,E	22-10 [1]	0,51

[1] for 322-LFS-DS: 26 - 12 AWG

Options / Accessories

- Marking options on the screw guides
- Cover caps A-323 und base plate B-323 for additional contact protection
- Insulation receptacles ISO-110
- Lowered solder tag for larger creepage distances to the screw
- Solder tag with two holes
- Moulding made of special polyamide for e.g. household appliances