

# 830-A-121-SMD

PCB connector for SMD

Push-In connection vertical to PCB

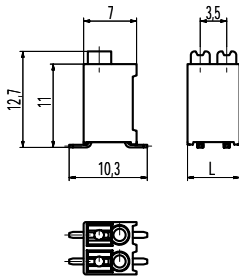

## PCB Layout (Recommendation)

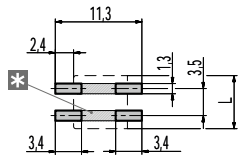

L = (No. of poles) x pitch  
L1 = (No. of poles - 1) x pitch  
Solder paste thickness: 0,15 - 0,2 mm

\* = Both solder pads of each pole can be connected together.

The PCB terminal block 830-A-121-SMD with the pitch of 3,5 mm offers strong performance in the smallest space. It is available in 2- and 3-pole design.

The position of the entries in vertical to the printed circuit board enables the advantageous application within housings with external connection. Due to the very small space requirement and the white colour it is ideally suited to various applications in the lighting industry.

The top of the terminal is equipped with pushers to be handled with standard screwdrivers for the removal of the parallel connected conductors.

The easy to use spring system allows beside the use of 1 mm<sup>2</sup> solid wires also the connection of 0,75 mm<sup>2</sup> flexible by use of the pushers.

The advanced design of this high temperature resistant terminal allows in the area of the solder pins the free circulation of hot air in the convection oven during the reflow soldering process.

This product is suitable for its automatic pick & place in the production line.

## Part Numbers

| No. of poles | 830-A-121-SMD               | Length | PU |
|--------------|-----------------------------|--------|----|
| 2            | 10.813.032.B00 (1 bar mag.) | 6,90   | 75 |
| 3            | 10.813.033.B00 (1 bar mag.) | 10,40  | 50 |

## General Information

|                      |                              |
|----------------------|------------------------------|
| Pitch                | 3,5 mm                       |
| No. of poles         | 2 + 3                        |
| Areas of application | Lighting technology, devices |

## Technical Data

|                          |  |        |        |
|--------------------------|--|--------|--------|
| Clamping Range           | <i>solid / flexible / AWG</i>  |        |        |
|                          | 0,2 - 1,0 mm <sup>2</sup> / 0,2 - 0,75 mm <sup>2</sup> / 24 - 18 AWG         |        |        |
| Rated Cross Section      | 1 mm <sup>2</sup> (starr / solid) / 0,75 mm <sup>2</sup>                     |        |        |
| Wire Stripping Length    | 7,5 mm ± 0,5 mm  |        |        |
| Overvoltage Category     | III  | III    | II     |
| Pollution Severity Level | 3  | 2      | 2      |
| Rated Voltage            | 160 V  | 160 V  | 320 V  |
| Rated Impulse Voltage    | 2,5 kV   | 2,5 kV | 2,5 kV |
| Rated Insulation Voltage | 130 V acc. to EN 60998-1   |        |        |
| Rated Current            | 13,5 A apply to 1 mm <sup>2</sup> solid<br>9 A apply to 0,75 mm <sup>2</sup> |        |        |
| Soldering process        | Reflow solder  |        |        |

## Material

|                            |   |
|----------------------------|---|
| Moulding                   | PA HT, white, V-0   |
| Comparative Tracking Index | CTI ≥ 600   |
| Insulating Group           | I   |
| Temperature Range          | -40°C up to 120°C; reflow solder temperature peak max. 255°C acc. to DIN EN 61760-1 |
| Terminal body              | Tin plated copper alloy   |
| Spring                     | Stainless steel   |

## Approvals

|   | Current [A] | Voltage [V] | Group | AWG     | [Nm] |
|---|-------------|-------------|-------|---------|------|
|  | 6           | 300         | B     | 24 - 18 |      |

## Options / Accessories

- Black colour on request
- Tape-on-Reel on request

## Part Numbers: Tape-on-Reel

| No. of poles | 830-A-121-SMD  | Tape Width | Tape Height | PU  |
|--------------|----------------|------------|-------------|-----|
| 2            | 10.813.032.A00 | 24 mm      | 14,4 mm     | 300 |
| 3            | 10.813.033.A00 | 24 mm      | 14,4 mm     | 300 |