

830-A-121-THR

PCB connector for SMD

Push-In connection vertical to PCB

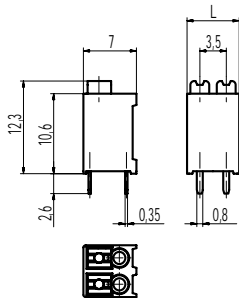

PCB Layout (Recommendation)

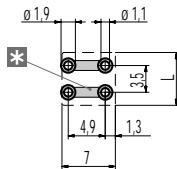

L = (No. of poles) x pitch

L1 = (No. of poles - 1) x pitch

Solder paste thickness: 0,15 - 0,2 mm

solder pad, outside diameter: \varnothing 1,9 mm

* = Both solder pads of each pole can be connected together.

The PCB terminal block 830-A-121-THR with the pitch of 3,5 mm offers strong performance in the smallest space. It is available in 2- and 3-pole design.

The position of the entries vertical to the printed circuit board enables the advantageous application within housings with external connection. Due to the very small space requirement and the white colour it is ideally suited to various applications in the lighting industry.

The front of the terminal is equipped with pushers to be handled with standard screwdrivers for the removal of the parallel connected conductors.

The easy to use spring system allows beside the use of 1 mm² solid wires also the connection of 0,75 mm² flexible by use of the pushers.

The advanced design of this high temperature resistant terminal allows in the area of the solder pins the free circulation of hot air in the convection oven during the reflow soldering process.

Part Numbers

No. of poles	830-A-121-THR	Length	PU
2	10.813.082	6,90	250
3	10.813.083	10,40	250
2	10.813.082.B00 (1 bar mag.)	6,90	75
3	10.813.083.B00 (1 bar mag.)	10,40	50

General Information

Pitch	3,5 mm
No. of poles	2 + 3
Areas of application	Lighting technology, devices

Technical Data

Clamping Range	<i>solid / flexible / AWG</i>		
	0,2 - 1,0 mm ² / 0,2 - 0,75 mm ² / 24 - 18 AWG		
Rated Cross Section	1 mm ² (starr / solid) / 0,75 mm ²		
Wire Stripping Length	7,5 mm \pm 0,5 mm		
Overvoltage Category	III	III	II
Pollution Severity Level	3	2	2
Rated Voltage	160 V	160 V	320 V
Rated Impulse Voltage	2,5 kV	2,5 kV	2,5 kV
Rated Insulation Voltage	130 V acc. to EN 60998-1		
Rated Current	13,5 A apply to 1 mm ² solid 9 A apply to 0,75 mm ²		
Soldering process	Wave solder & reflow solder		
Hole in PCB	\varnothing 1,1 mm		

Material

Moulding	PA HT, white, V-0
Comparative Tracking Index	CTI \geq 600
Insulating Group	I
Temperature Range	-40°C up to 120°C; reflow solder temperature peak max. 255°C acc. to DIN EN 61760-1
Terminal body	Tin plated copper alloy
Spring	Stainless steel

Approvals

	Current [A]	Voltage [V]	Group	AWG	[Nm]
	6	300	B	24 - 18	

Options / Accessories

- Black colour on request
- Tape-on-Reel on request

Part Numbers: Tape-on-Reel

No. of poles	830-A-121-THR	Tape Width	Tape Height	PU
2	10.813.082.A00	24 mm	17,2 mm	300
3	10.813.083.A00	24 mm	17,2 mm	300