

PCB bridge 930-LC-111

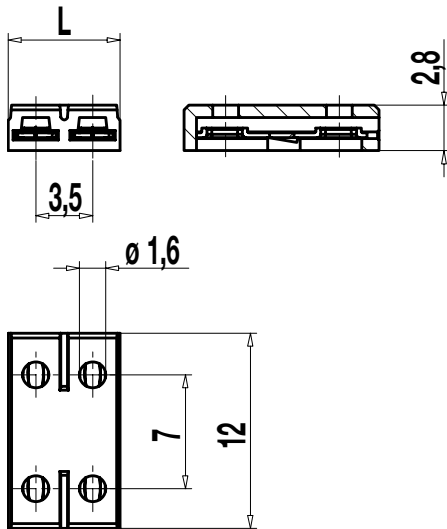

The PCB bridge 930-LC-111 with 3.5 mm pitch is designed as a connection solution for adjacent circuit boards. It works in conjunction with the pin strip 931-SLT-SMD-1,1-L4 with a height of 4 mm.

The connector is designed for applications with 6A / 250 V. The height of the assembled connection of 930-LC-111 and 931-SLT-SMD-1,1-L4 is only 4.5 mm. The housing of the 930-LC-111 has test connections and access to the contact surfaces.

PCB bridge 930-LC-111 is offered as a connectivity solution for the LED related panel-to-panel easy interconnect. It is suitable to bridge together LED PCBs via surface mounted pin strips. The Bridge is designed for easy removal and replacement for one particular PCB within a PCB chain. Its ergonomic design makes installation of PCB panels easy to access and maintain.

Part Numbers

No. of poles	930-LC-111	Length	PU
2	10.893.752	6,9	250
3	10.893.753	10,4	250

General Information

Pitch	3,5 mm
No. of poles	2 + 3
Usable with	931-SLT-SMD-1,1-L4
Areas of application	Lighting application

Technical Data

Overvoltage Category	III	III	II
Pollution Severity Level	3	2	2
Rated Voltage	125 V	160 V	320 V
Rated Impulse Voltage	2,5 kV	2,5 kV	2,5 kV
Rated Insulation Voltage	130 V acc. to EN 60998-1		
Rated Current	6 A		

Material

Moulding	PA, white, V-0
Comparative Tracking Index	CTI ≥ 600
Insulating Group	I
Temperature Range	-40°C up to 100°C
Contact elements	Copper alloy, bare

Approvals

	Current	Voltage	Group	AWG	Nm
	6 [1]	250			

[1] Acc. to UL 1977 and C22.2 No. 182.3