

## 971-FB

Socket terminal strip  
Plug connection, plug-in direction vertical to PCB

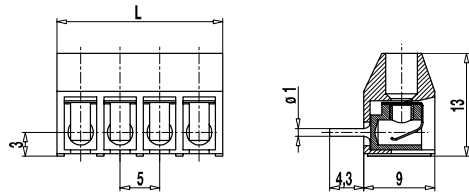
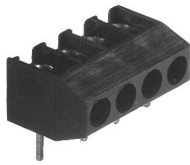

The socket terminal strip 971-FB with a pitch of 5 mm is available with 2 to 32 poles. In order to achieve a higher housing strength, these socket terminal strips cannot be mounted side-by-side without pole loss.

It is suitable for a parallel connection of two PCBs, when using male pin strips of the series 971-SLR, -SLS oder -SLW. For this version, the plug direction for mating connectors is vertical to the PCB.

The contact pressure is achieved by means of a stainless steel spring with extra-long spring deflection. Due to the high spring forces, it is advisable to select the socket terminal strip with only up to 8 poles.

For longer clearance and creepage distances, socket terminal strips are also available in a larger pitch.

The socket terminal strip 971-FB only differs from the smaller 951-FB version by the M3 screws and longer clearance and creepage distances. It is fully compatible to versions 951-SV, 97...-FBW and -FBS.

### Part Numbers

No. of poles	971-FB	Length	PU
2	85.872.152	11,00	250
3	85.872.153	16,00	250
4	85.872.154	21,00	200
5	85.872.155	26,00	100
6	85.872.156	31,00	100
7	85.872.157	36,00	100
8	85.872.158	41,00	100
9	85.872.159	46,00	100
10	85.872.160	51,00	100
11	85.872.161	56,00	100
12	85.872.162	61,00	100
13	85.872.163	66,00	100
14	85.872.164	71,00	100
15	85.872.165	76,00	100
16	85.872.166	81,00	100
17	85.872.167	86,00	100
18	85.872.168	91,00	100
20	85.872.170	101,00	100
22	85.872.172	111,00	100
24	85.872.174	121,00	100
26	85.872.176	131,00	100
28	85.872.178	141,00	100

further number of poles on request

### General Information

Pitch	5 mm
No. of poles	2 - 32
Usable with	plug connector 971-SV



### Technical Data

Overvoltage Category	III	III	II
Pollution Severity Level	3	2	2
Rated Voltage	250 V	320 V	630 V (500 V)
Rated Impulse Voltage	4 kV	4 kV	4 kV
Rated Current	6 A		
Hole in PCB	ø 1,3 mm		
Other specifications	Voltage data in brackets are valid for 9-32 poles types. 2-8 poles types are "no-flame" acc. to glow-wire test.		

### Material

Moulding	PA, grey, V-0
Comparative Tracking Index	2-8 poles: CTI ≥ 600; 9-32 poles: CTI 400
Insulating Group	2-8 poles: I; 9-32 poles: II
Temperature Range	-40°C up to 100°C
Terminal body	Tin plated brass
Solder pin	ø 1 mm; tin plated brass
Spring	Stainless strip steel

### Approvals

	Current [A]	Voltage [V]	Group	AWG	[Nm]
	20	300	B		
	10	300	D		
	20	300	B		
	10	300	D, E		
	Current [A]	Voltage [V]	[mm <sup>2</sup> ]		
	17,5	250 [1]			

[1] Acc. to IEC 60947-7-4 und IEC 60947-1

### Options / Accessories

- Consecutive numbering
- Special marking according to drawing
- Self-adhesive marking strip BST-5,00
- Pitch of 10 mm for larger clearance and creepage distances
- Other P.C. pin lengths on request
- Version with lateral latching elements