

971-SLT-SMD

Pin strip for SMD
Low profile

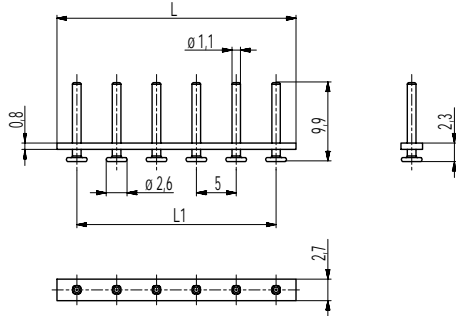

PCB Layout

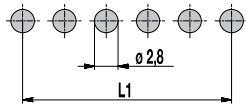

$L1 = (\text{No. of poles} - 1) \times \text{pitch}$
Solder paste thickness: 0,15 - 0,2 mm

971-SLT-SMD is a pin strip with a pitch of 5 mm for the application in a reflow soldering process with low profile for space critical applications. Contrary to the well-known pin strips of 971-SLR and 971-SLR-THR, for which holes in the PCB are necessary, the SMD types of WECO base on true surface assembly.

Soldering expands at the end of the pins guarantee optimal retention force on the printed circuit board.

We recommend this pin strip with pin diameter of 1,1 mm in the mating area for higher numbers of poles, in order to minimize the plug-in and withdrawal forces here.

Just like all THR versions of WECO, also the housings of the SMD series are made out of high temperature resistant plastic material.

For the automatic assembling all pin strips of this series are packed in Tape-on-Reel and equipped with high temperature resistant Pick Caps, which can easily be removed after the soldering process.

Part Numbers

No. of poles	971-SLT-SMD	Length	PU
2	12.893.656	10,00	1000
3	13.893.656	15,00	500
4	14.893.656	20,00	500
5	15.893.656	25,00	250
6	16.893.656	30,00	250
10	20.893.656	50,00	100

further number of poles on request

General Information

Pitch	5 mm
No. of poles	2 - 12
Usable with	plug connectors of series 115-F-.../..-1,1-SW; 950-FL-DS, 950-TFL-DS, 950-NAF-DS, 950-GFL-DS, 950-NLFL-DS, 950-RFL-DS
Additional Information	Also, please take into consideration the pin strips 971-SLR for wave soldering and 971-SLR-THR for Through-Hole-Reflow.



Technical Data

Overvoltage Category	III	III	II
Pollution Severity Level	3	2	2
Rated Voltage	160 V	160 V	250 V
Rated Impulse Voltage	2,5 kV	2,5 kV	2,5 kV
Rated Insulation Voltage	130 V acc. to EN 60998-1		
Rated Current	10 A		
Soldering process	Reflow solder		

Material

Moulding	PA HT, black, V-0
Comparative Tracking Index	CTI \geq 600
Insulating Group	I
Temperature Range	-40°C up to 120°C; reflow solder temperature (Peak) max. 255°C acc. to DIN EN 61760-1
Solder pin	\varnothing 1,1 mm (plug-in area); tin plated brass

Approvals

	Current [A]	Voltage [V]	Group	AWG	[Nm]
	10 [1]	300	B		
	10	300	B		

[1] Above headers with 1.0 or 1.1 mm dia. pins are rated 12A max. with manufacturer's Cat. No. 120-W-111 terminal blocks. Above headers with 1.1 mm or 1.3 mm dia. pins are rated 12A max. with 115-F-111, 115-F-211 and 115-F-118 terminal blocks.

Options / Accessories

- Other plug pin lengths on request
- Other solder pin surfaces on request

Part Numbers: Tape-on-Reel

No. of poles	971-SLT-SMD	Tape Width	Tape Height	PU
2	12.893.656.A00	32 mm	14,6 mm	500
4	14.893.656.A00	44 mm	15,0 mm	500
6	16.893.656.A00	44 mm	15,0 mm	500
10	20.893.656.A00	72 mm	14,9 mm	500

further number of poles on request