

322-A-2,8(-DS)

with Tabs A 2,8
1 – 12 poles



The end of the receptacles protrudes approx. 12,5 mm (0.50 in). Different accessories are available – e.g. insulation sleeves – see *Options*.

The screws are backed up, protected against self loosening and cannot be lost.

These tab/screw connectors can be combined with the 322-SV, described before. In this case, the plugs are pushed into the screw connection and screwed down tight.

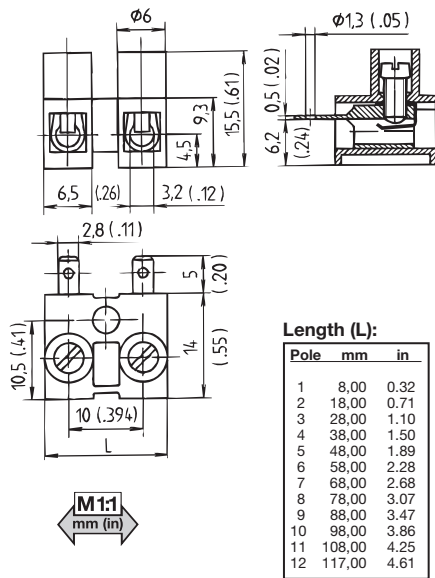

Order Table

Wire protector: with -DS w/o: No entry	Poles: 01 to 12
322-A-2,8 / <input type="text"/> / <input type="text"/>	
Type-Designation	

970-B-2,8(-DS)

with Tabs B 2,8
2 – 8 polig



The tab/screw connector rails 970-B-2,8 are very small because of their 5 mm spacing. They are particularly suitable for use as lead-out terminals. The housings are fitted with 2 side flanges for fastening. The inner terminals are constructed as flat-pin terminals 2.8 mm x 0.8 mm.

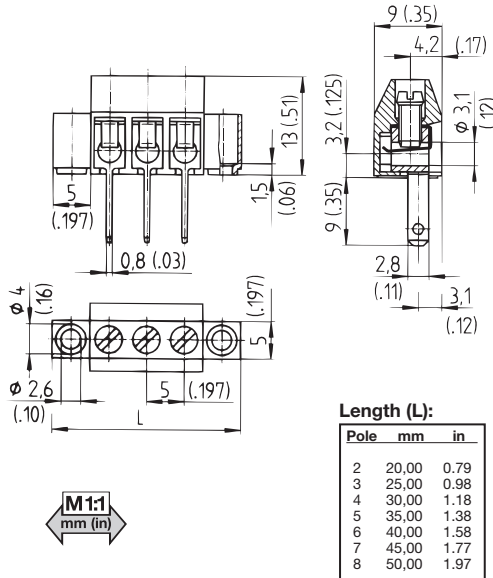

Order Table

Wire protector: with -DS w/o: No entry	Poles: 02 to 08
970-B-2,8 / <input type="text"/> / <input type="text"/>	
Type-Designation	



Technical Data

Rated Connecting Capacity:
Screw Side: 2,5 mm² / 14 AWG

Nominal Cross-Section:
Tab Side: 1 mm² max. / 22-16 AWG

Rated Insulation Voltage: 250 V to EN 60 998

Rated Voltage: 400 V
to DIN VDE 0110, pollution degree 2 / II

Rated Current: 6 A compare DIN 46 249

International Approvals



Data see page 74.

Material

Srew: M 3
Zinc plated steel, yellow chromated
⌚ max.0,5 Nm/4.5 lb-in

Further details
see General Description page 42.

Options

- Insulating sleeves, see page 52.
- Marking strips for 322-A-2,8(-DS), see page 31.
- Covers and base plates for type 322-A-2,8(-DS), see page 19.

Type 970-B-2,8(-DS):

- Consecutive numbering.
- Special marking, according to drawing.
- Self adhesive marking strips, see page 52.
- Designs with larger pole numbers.
- Design without fixing flanges.
- Connectors with wire entry funnel. see drawing page A 19.
- Double wire protector as jumper.

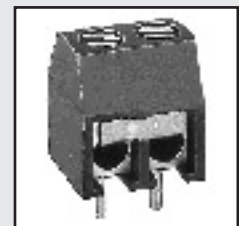

Double wire protector