

432-Z(-DS)

with Tabs 6,3
2 poles

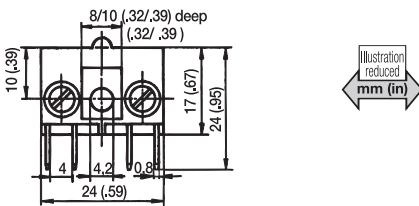
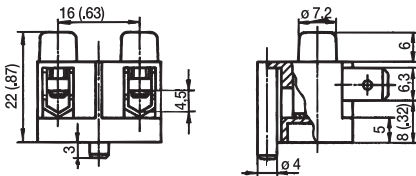
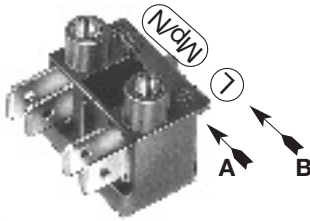

Illustration reduced mm (in)

433(-Z)(-DS)

with Tabs 6,3
3 poles

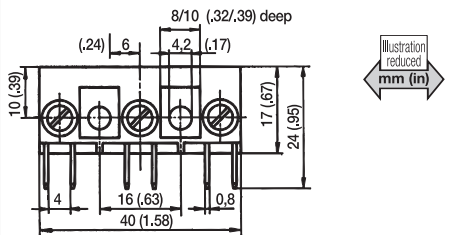
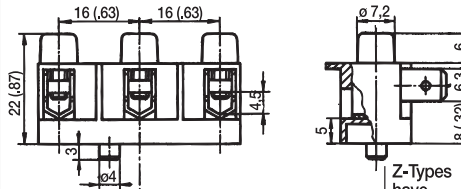
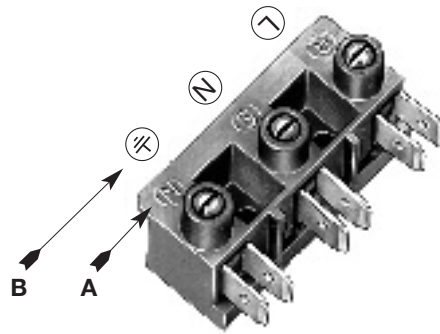

Illustration reduced mm (in)

Z-Types have a peg at the base



Technical Data

Rated Connecting Capacity: to EN 60 998
4 mm² / 14-10 AWG

Rated Insulation Voltage: 450 V to EN 60 998

Nominal Cross-Section:
Tab side: 6 mm² max./10 AWG max.

Rated Voltage: 400 V
to DIN VDE 0110, pollution degree 3 / II

Rated Current: to DIN 46 249
Tab Side: 25 A

The metal part on the mains and the equipment side consists of one piece so that contact resistances within the terminal do not apply. The thread M 3,5 is in accordance with VDE 0700. The terminal can therefore be used for connecting motordriven equipment with rated currents up to 16 A to the mains. Types -Z have a peg projecting at their base. This enables them to be firmly attached to a correspondingly prepared base using only one screw. Typ 433-L...(-DS) has no peg but two mounting holes.

International Approvals



Data see page 74.

Material

Screw: M 3,5;
Zinc plated steel, yellow chromated
⤷ max. 0,8 Nm/7 lb-in

Further details
see General Description page 42.

Options

➤ Different pole markings on types 432/433.

Order Table

Design: (with pegs at the base) → Z	Marking: (R Mp/N) → A (L Mp/N) → B	Wire protector: with → -DS w/o: No entry
4 3 2 - Z		
Type-Designation		

Order Table

Design: (with pegs) → Z (w/o pegs) → L	Marking: (R S N) → A (L N ≠) → B	Wire protector: with → -DS w/o: No entry
4 3 3 -		
Type-Designation		